



SAGEWOOD
L I F E S T Y L E A P A R T M E N T S



Sagewood Lifestyle Apartments is a new residential development consisting of 270 apartments in an array of 1-bedroom, 2-bedroom or 3-bedroom configurations. Conveniently located on Olifantsfontein Road, in Midrand, this estate is in close proximity to several schools, shopping centres and office nodes. A singular gatehouse allows for tight security measures to be implemented, to safeguard every resident family. A central clubhouse is located at the entrance and overlooks a large swimming pool with children's play area, whilst providing a double-storey gym, communal lounge, meeting room and laundry area. These facilities clearly illustrate the spectacular quality of life that all our tenants can enjoy.



- Gatehouse with Security Office
- Children's Play Park
- Clubhouse: Laundry Room
- Leasing and Admin Office
- Clubhouse: Meeting Room
- Braai Pavilions
- Clubhouse: Double-storey Gym
- Swimming Pool
- Clubhouse: Lounge



3-Bedroom Apartment

- 3 x Bedrooms
- 2 x Bathrooms
- Unit Size: 76m² (incl. Patio)

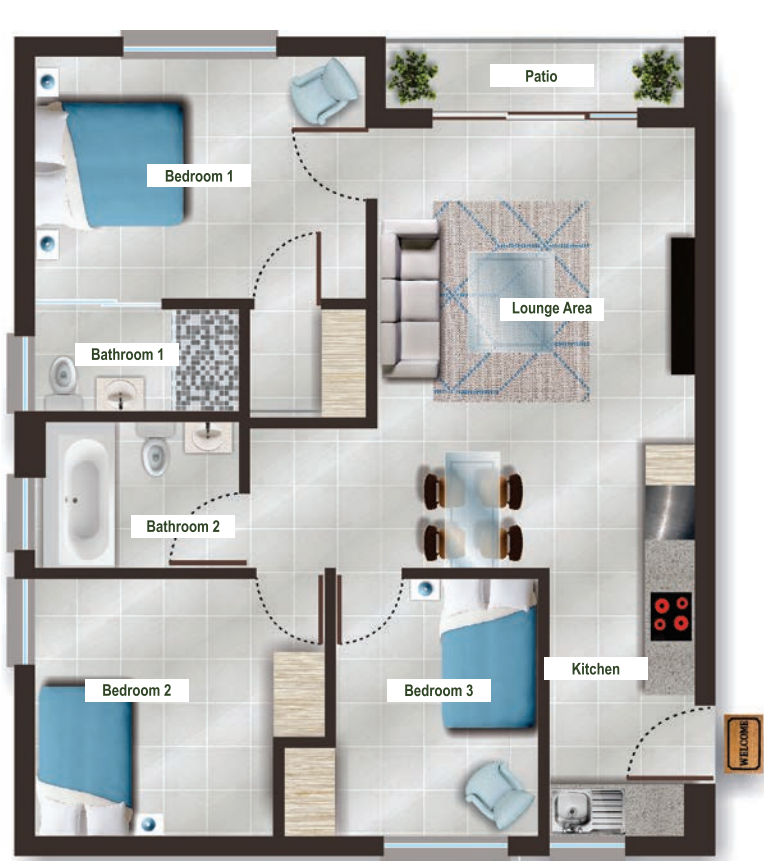

2-Bedroom Apartment

- 2 x Bedrooms
- 2 x Bathrooms
- Unit Size: 68m² (incl. Patio)



1-Bedroom Apartment A

- 1 x Bedrooms
- 1 x Bathrooms
- Unit Size: 43m² (incl. Patio)

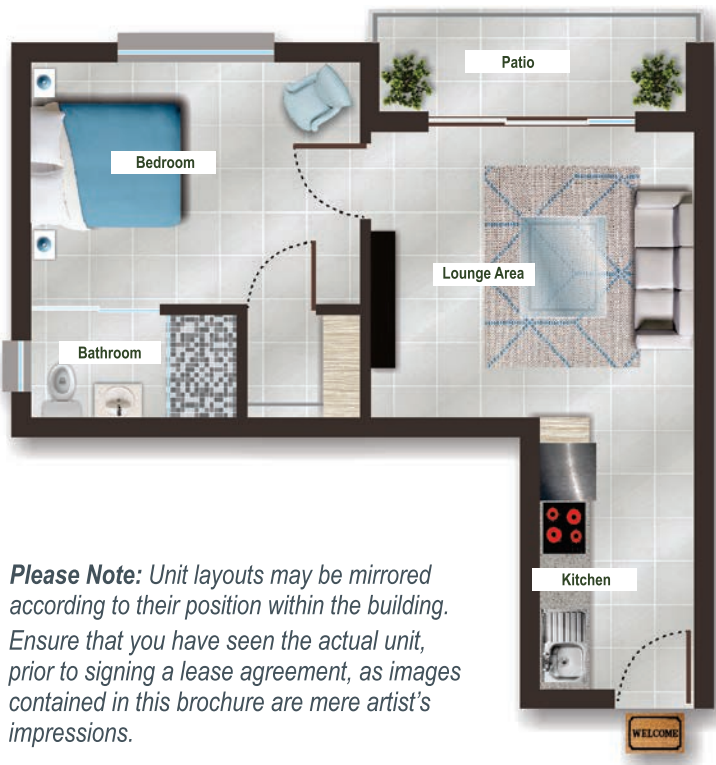

Please Note: Unit layouts may be mirrored according to their position within the building. Ensure that you have seen the actual unit, prior to signing a lease agreement, as images contained in this brochure are mere artist's impressions.

1-Bedroom Apartment B

- 1 x Bedrooms
- 1 x Bathrooms
- Unit Size: 30m²



These units include a **FREE** internet connection. All external maintenance as well as the use of the clubhouse with gym are also included in the rent.





- Tenants have **a choice of different apartment layouts**; 3-bed, 2-bed or 1-bed apartments and FREE internet.
- A single gatehouse (access point) allows for **tight security control**, 24 hours a day with a secure perimeter.
- Sagewood Lifestyle Apartments are in close proximity to several **schools and shopping facilities**.
- The estate has a **clubhouse** with double-storey gym, communal lounges overlooking a large swimming pool.
- **Care-free living** as garden maintenance and general building maintenance is included in the monthly rental.
- The estate is **family-orientated** with a children's play park and a pavilion with braai facilities.
- Units have **modern fittings and finishes** to ensure a contemporary urban lifestyle in a spacious environment.
- This estate forms part of the **Houss Rentals portfolio**, with thousands of upmarket rental units in their care.



Kids' Play Park



Communal Lounge



Double-storey Gym



Swimming Pool

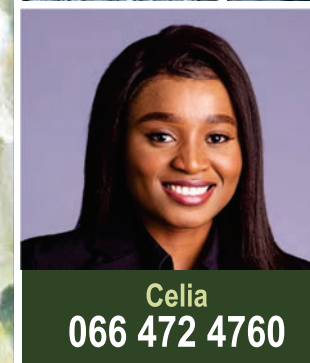

For more information, please visit
www.houss.co.za

Sales office hours:
09h00-17h00, 7 days a week



Other exciting RENTAL projects currently on show by HOUSS:



The Precinct Luxury Apartments
Vuyo: 082 371 7613



Carlswald Luxury Apartments
Celia: 066 472 4760



The Oval Apartments @ The Hills
Darren: 066 054 4663



The Parks, Riversands
Joy: 066 471 9818



The Villas, Waterfall
Georgia: 083 644 4323



Crowthorne Luxury Apartments
Shepherd: 079 078 5518

For more information on any of these developments, contact us on **0800 736825**